

# ELECTRIC BICYCLE USER MANUAL

Applicable Models: LIGHT-P2

Tips:  
Please read all product manuals carefully before riding.  
Please keep it properly after reading. Please do not use an electric bicycle before you understand its characteristics.



## Accessories

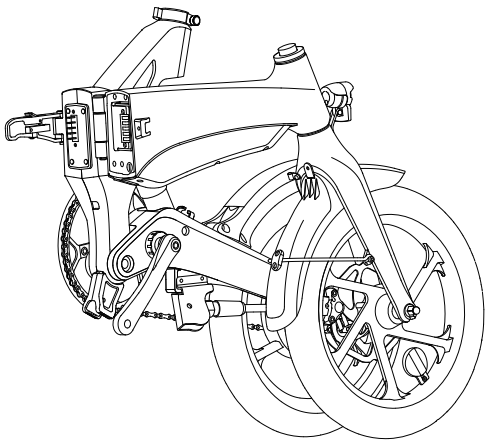
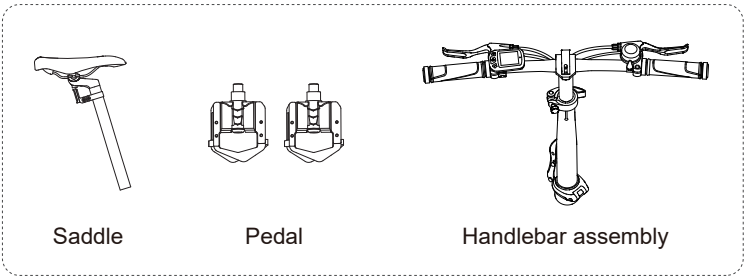
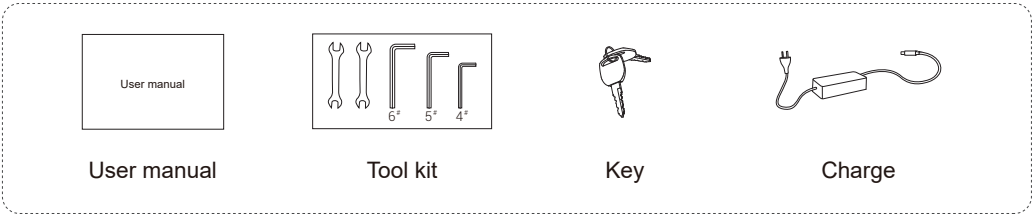

LIGHT-P2 Folding E-Bike

\*Please carefully check whether the items in the packaging box are complete and intact. If there are any missing or damaged items, please consult your dealer.

## Parts description

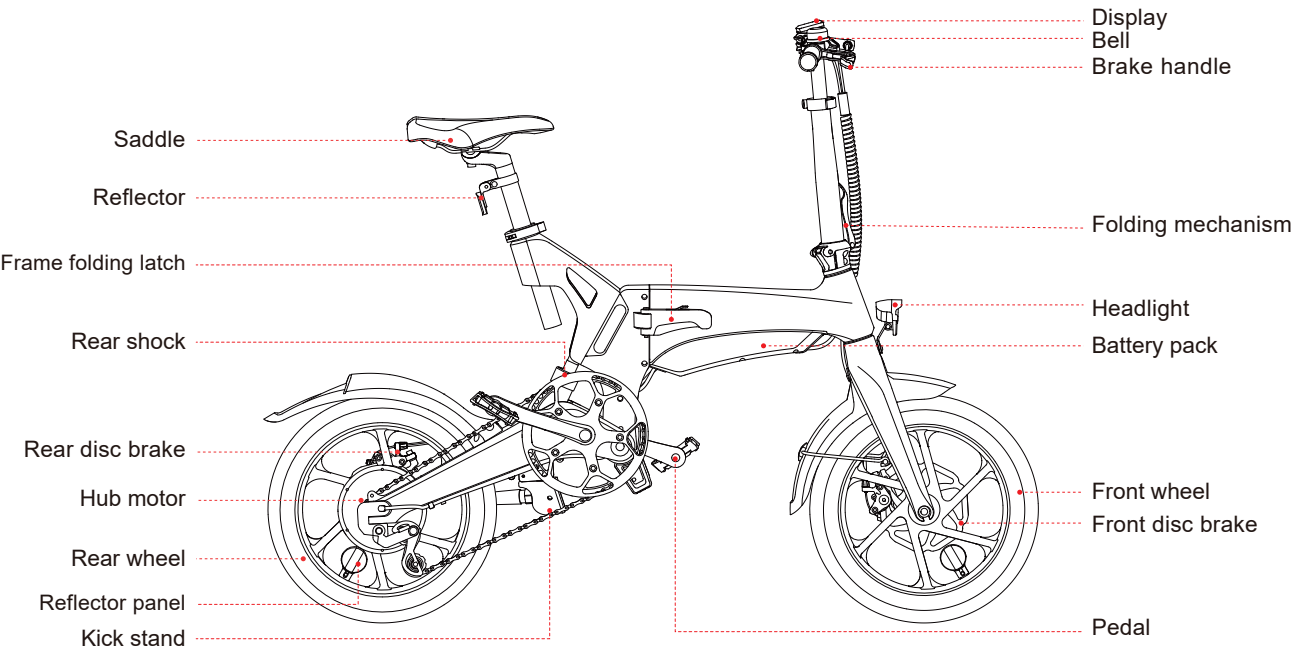

## Product specifications

Types	Parameters	LIGHT-P2
Information	Size	1380*570*1040-1160mm (Pole adjustable)
	Weight	22 kg
Configuration	Payload Capacity	85 kg
	Sensor	Torque sensor
	Brake (Front/Rear)	160MM Front and Rear Disc Brakes
	Tire	16*2.125 Inch
	Speed	24km/h
	Range	Up to 70km
	Battery	36V 7.65Ah
	Motor	250W
Lighting	Display	LCD
	Headlight	LED headlights
	Rear taillight	/
Charger	Voltage	42V 2A
	Charging time	3-5h

## Folding Instructions

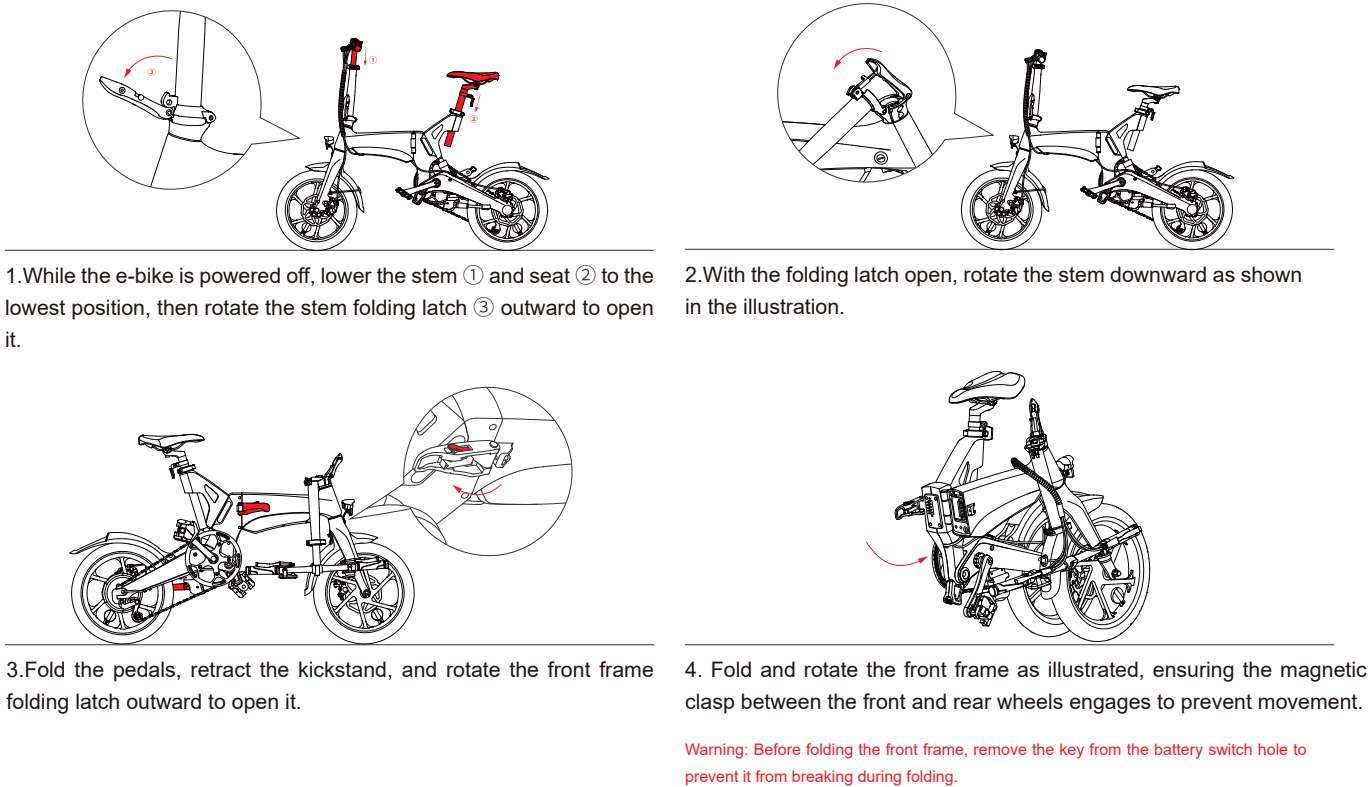

Assembly Instructions

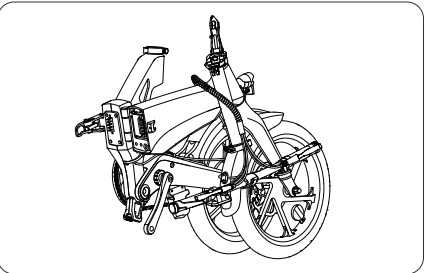

1.The bicycle is folded when taken out. First, remove the protective foam from the bike.

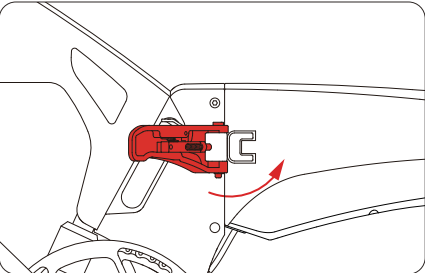

2.Unfold the frame and rotate the folding latch toward the frame to lock it securely.

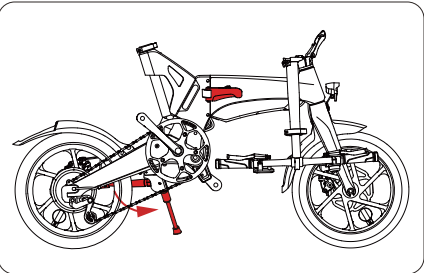

3.Check if the latch is fully secured, then lower the kickstand.

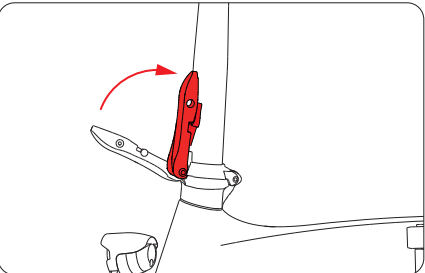

4.Stand the stem upright and rotate the folding latch inward to lock it securely.

Saddle Clamp Adjustment

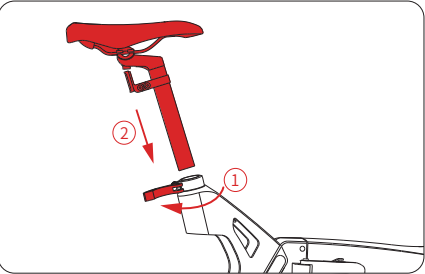

1.Install the saddle by rotating the seat clamp ① outward, then inserting the saddle post ② into the seat tube.

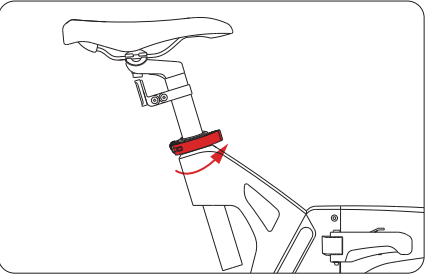

2.Lock the folding latch inward and check if the saddle is stable.

Pedal Assembly Procedure

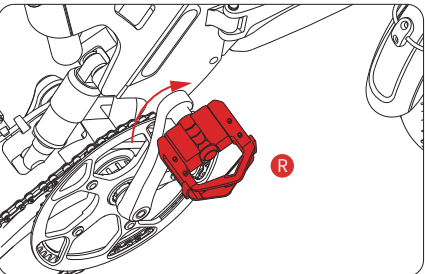

Install the pedals, ensuring proper left/right identification. Tighten the right pedal clockwise and the left pedal counterclockwise.

Battery Removal Method

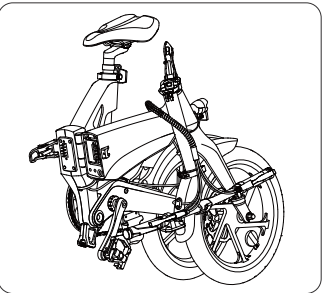

1.Fold the bike.

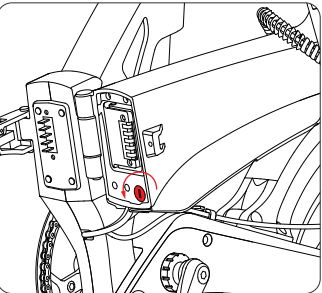

2.Rotate the key to the left to unlock the battery.

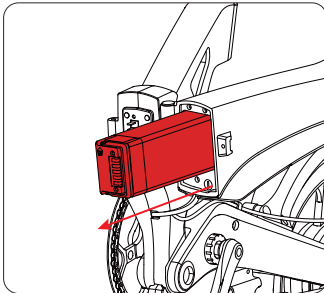

3.Pull the battery handle outward to remove it.

How to charge

Due to battery self-consumption during transportation and storage, it is normal for the battery to be low or empty when used for the first time. Please charge according to the following charging steps. Do not allow minors to use the charging equipment.

External charging

To charge the battery, remove it using the key, locate the charging port on the left side of the battery case, and open the rubber cap. Plug the charger into a power outlet, then connect the output end of the charger to the charging port on the battery case. After charging is complete, unplug the charger, close the rubber cap, and reinstall the battery.

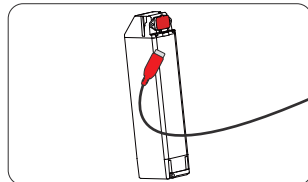
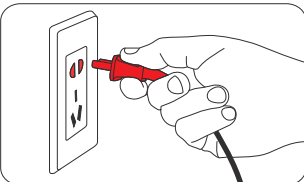
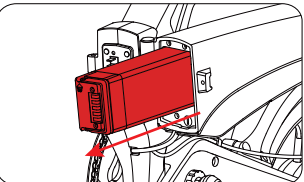

\*The red light of the charger means the battery is charging. The green light means the battery is charged. Please turn off the power after the battery is fully charged. If the temperature of the e-bike body exceeds 40°C , the battery will not be charged normally. Please wait until it drops below 40°C before charging.

Head combination switch

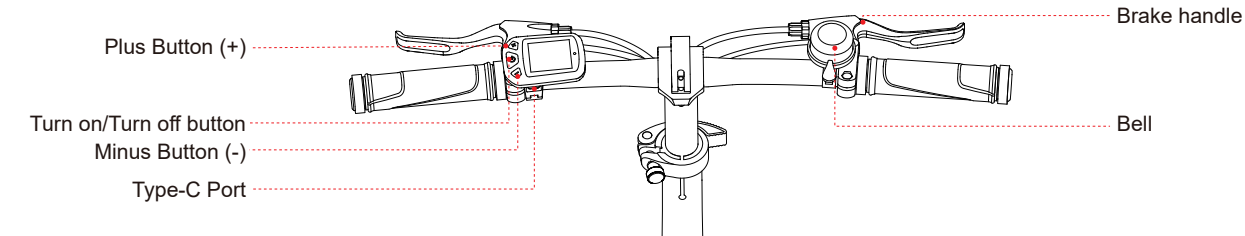

	Short press	Long press	Long press and hold
	Switch data display style	Turn on/Turn off	/
	Boost gear	E-bike light switch	Standby Settings: Wheel Diameter Settings Speed Limit Settings: Backlight Settings Unit Settings: Trip Reset
	Power-down gear	Assist Mode	

Frame and Motor Codes

The number is engraved on the end cover of the motor as shown in the figure below:

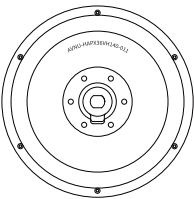

The location of the frame number is shown in the figure below:

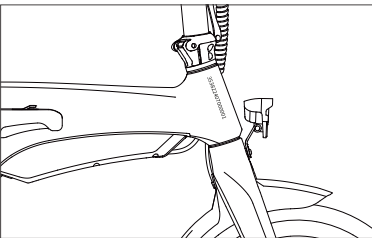

Display

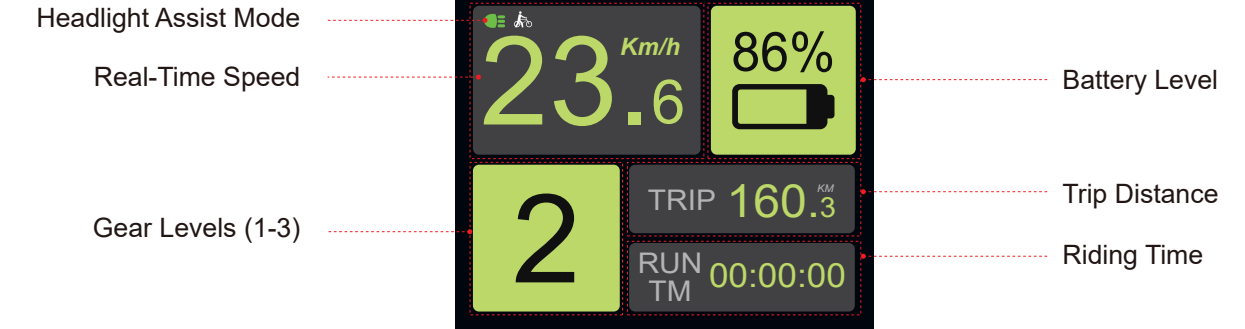

Error code meaning sheet

Warning Codes	Fault Status	Error Codes (Decimal)	Fault Status
101	Brake Lever Power Not Reset	34	Motor Stalled
102	Throttle Power Not Reset	35	Motor Phase Wire Disconnected
103	Throttle Ground Wire Disconnected	36	Motor Hall Sensor Wire Disconnected
105	No Signal from Speed Sensor	52	Controller Does Not Support Command (Needs Upgrade)
24	Controller Overcurrent	*Some error codes unrelated to this vehicle are not listed.	
25	Controller Undervoltage		
26	Controller Overvoltage		