

ELECTRIC SCOOTER USER MANUAL

Applicable Models: BESTRIDE PRO-F2

Tips:
Please read all product manuals carefully before riding.
Please keep it properly after reading. Please do not use an electric scooter before you understand its characteristics.

Accessories

User information

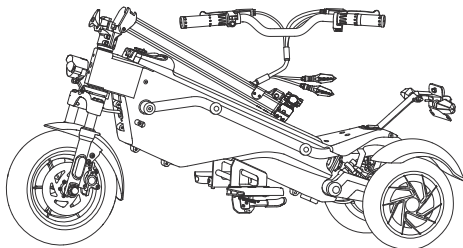
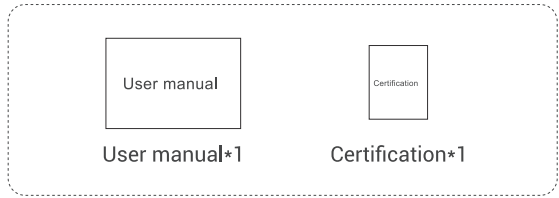

scooter body*1

Accessories

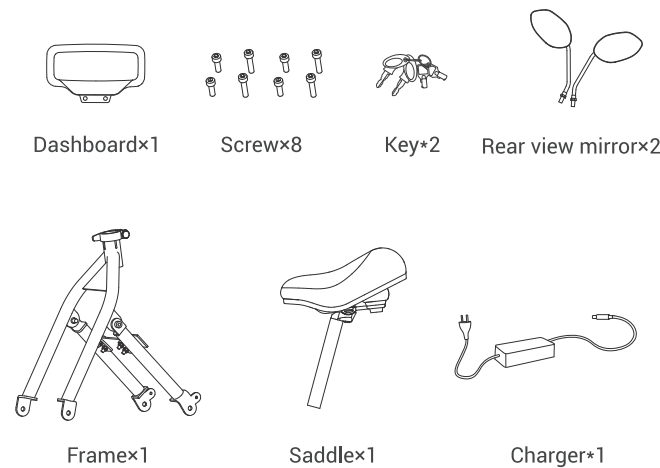

Please carefully check whether the items in the packaging box are complete and in fact of any missing or broken items.

Parts description

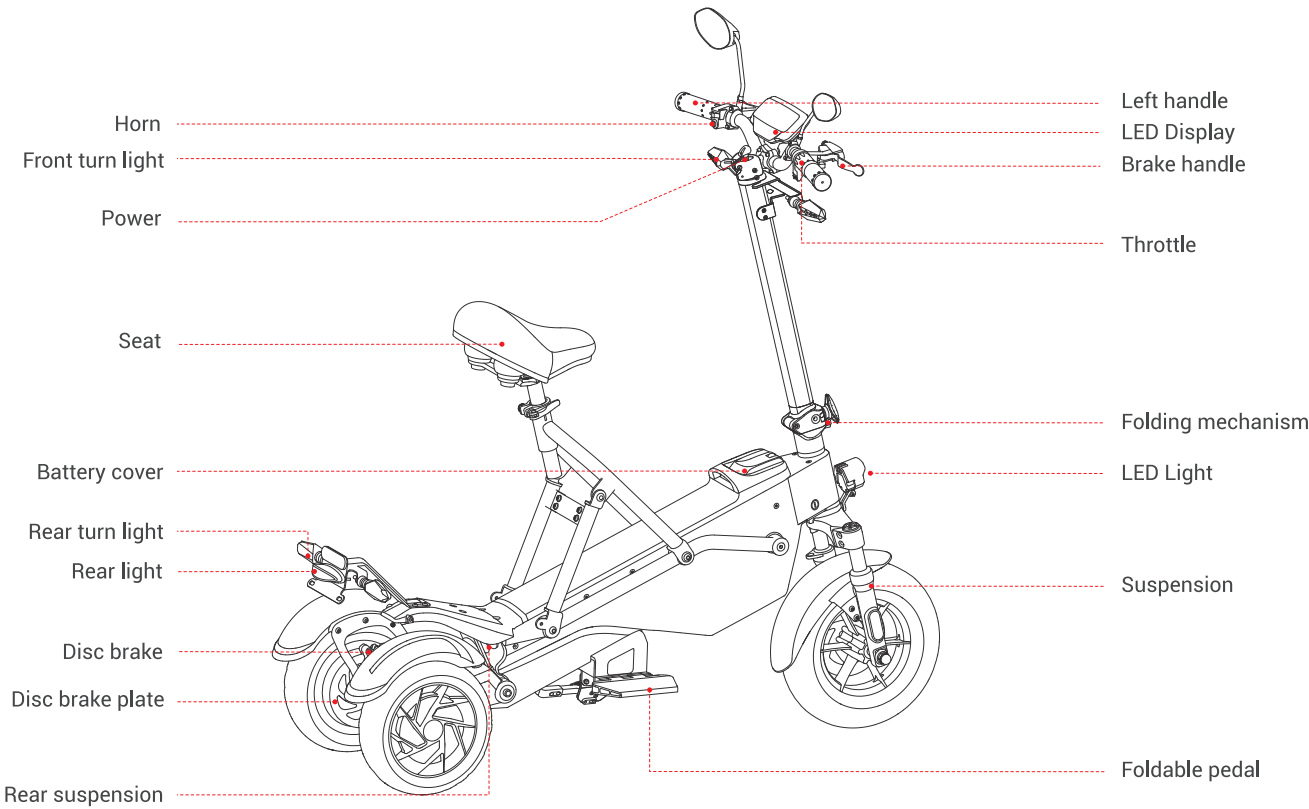

Product specifications

Model	BESTRIDE PRO-F2
Maximum battery capacity	23.4Ah
Range	About 45km
Motor	48V500W*2
Tire	Front 12 inch rear 10 inch tubeless air tire
Standard working voltage	48V
Battery Type	Lithium battery
Brake	front and rear disc brake
Rated maximum load	150Kg
Lights	Headlights
Net weight/Gross weight	53Kg/63Kg
Expanded size	1280*605*1260mm
Storage temperature	0℃~35℃
Charging temperature	10~35℃

Display

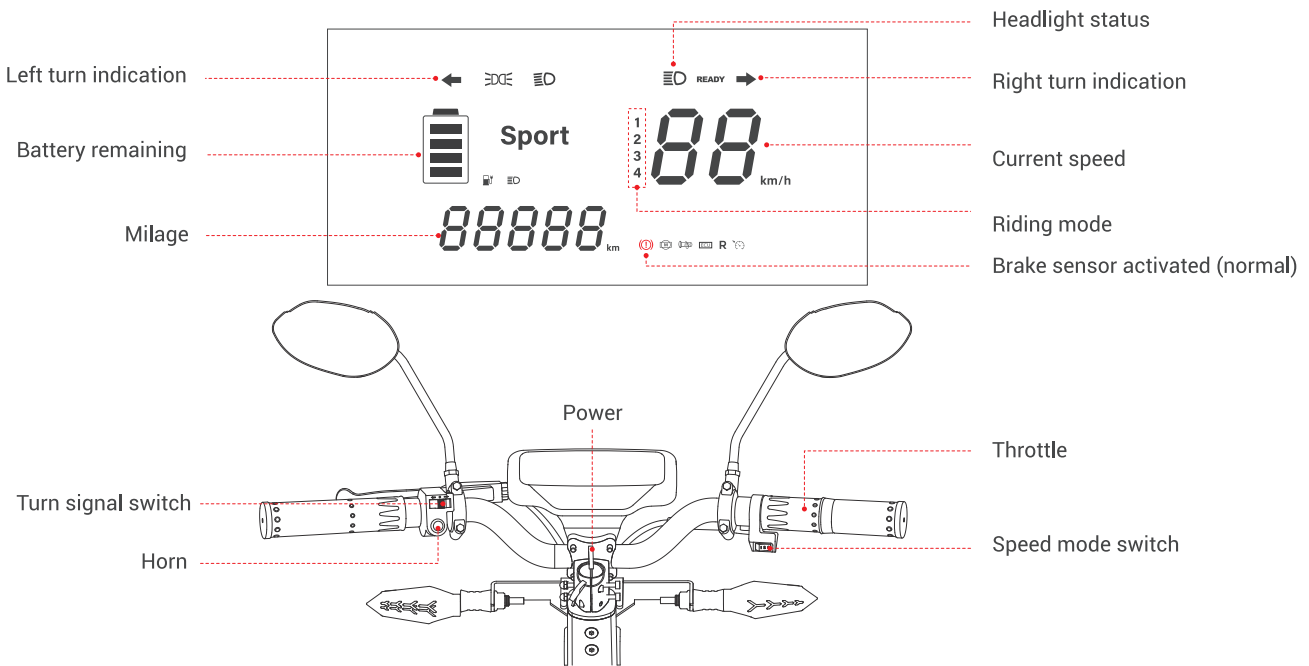

- When the power is turned on for the first time, the accumulated distance will be displayed, which will be displayed as the current driving mileage and reset to zero when restarted.
- If the warning sign is abnormal, please contact customer service center for consultation.

Installation Instructions

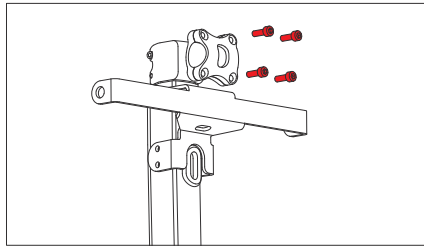

1. Unscrew the four screws.

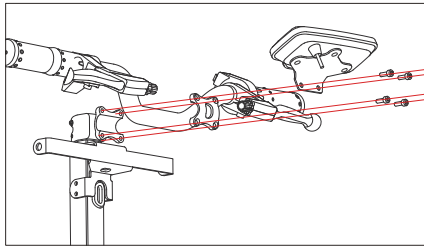

2. Place the elbow and instrument panel as shown in the figure, align the holes and tighten them with screws.

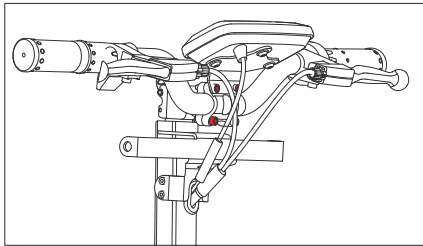

3. Dashboard wires and power cord connect them.

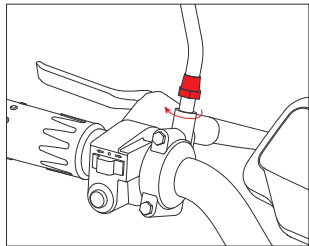

4. As shown in the figure, screw the rear view mirror clockwise to the proper position.

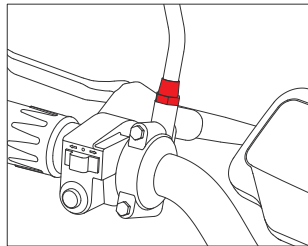

5. Tighten the nut at the bottom of the rear-view mirror clockwise.

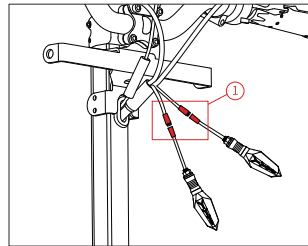

6. Separate the power connection wire at ① as shown in the figure, and unscrew the nut on the steering lamp.

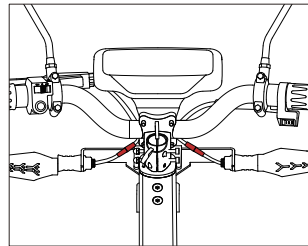

7. Insert the unscrewed lamp caps into the holes on the pole holder, screw on the nuts, tighten them counterclockwise, and finally connect the power cord.

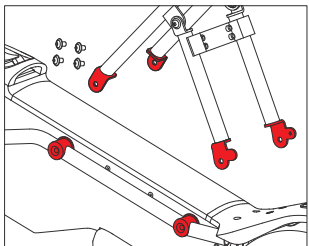

8. Find out the four screws, as shown in the picture, align the frame with the holes on both sides of the scooter.

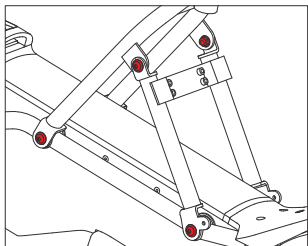

9. Tighten the screws.

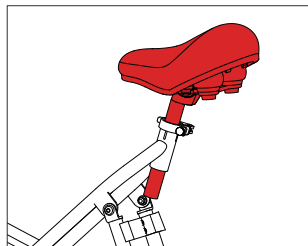

10. Insert the saddle as shown.

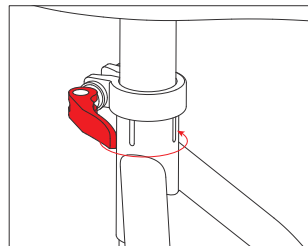

11. Please ensure that the seat does not flip back or shake when pressed, and the latch is fastened in the direction shown in the picture.

Pole folding method

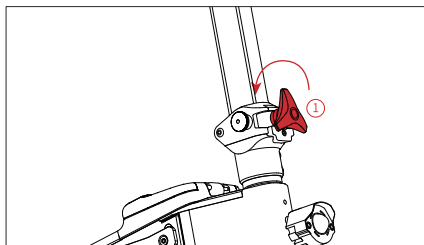

1. As shown in the picture, rotate the marked red part ① to the left

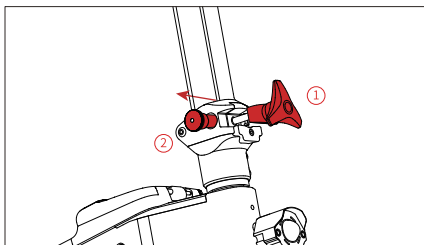

2. After completely rotating ① out, pull out ② and snap it back to lock it

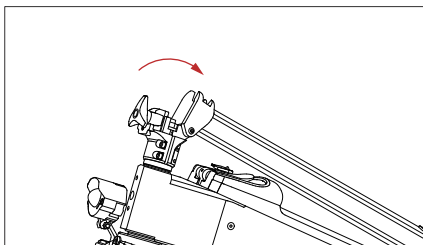

3. Lower the pole in the direction as shown in the picture

Note: This product needs to be folded after the frame is disassembled. Please confirm whether the frame has been disassembled before folding.

How to ride

1. Preparation:

There is a risk of falling and injury, so wear a helmet and protective gear all the time.

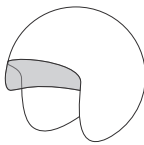

Helmet

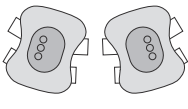

Protective

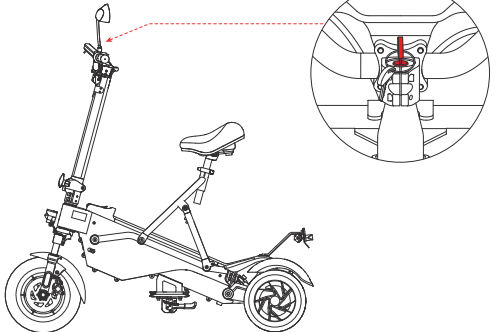
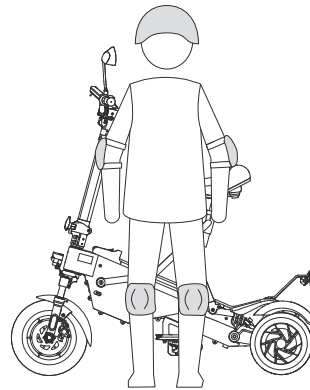

2. Power on: Turn the key clockwise to unlock and power on. And check the power indicator. If the power is too low, please charge it immediately.

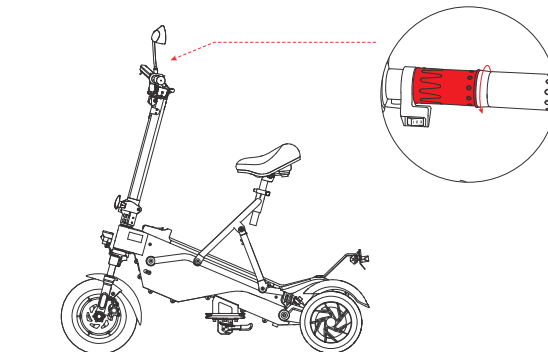

3. Start: before riding, straighten the body, adjust the sitting position, ensure it's on low speed level, turn the throttle slowly, and touch the ground with both feet; When the scooter is moving smoothly, retract your feet and place them on the pedals.

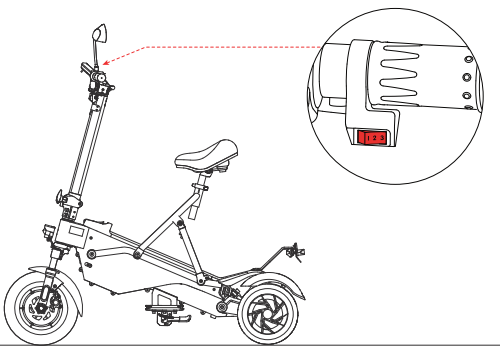

4. Speed switch: You can change speed from 1 to 3 by the speed switch.

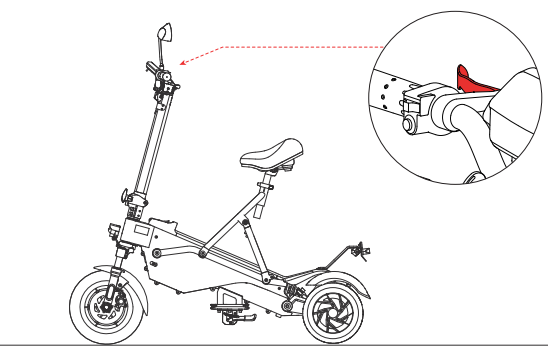

5. Decelerate/brake: release throttle to decelerate. Emergency braking requires rapid pressure on the brake handlebars.

Warning: Quick braking may fall due to insufficient.

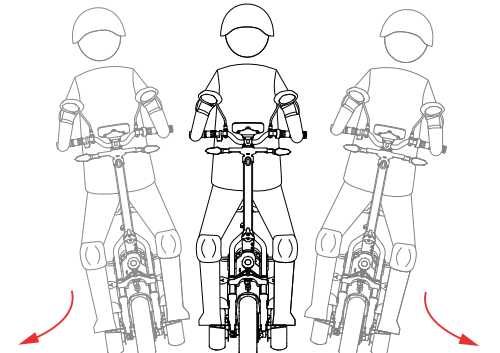

6. Turning: When turning, lean your center of gravity slightly and slowly turn your handle.

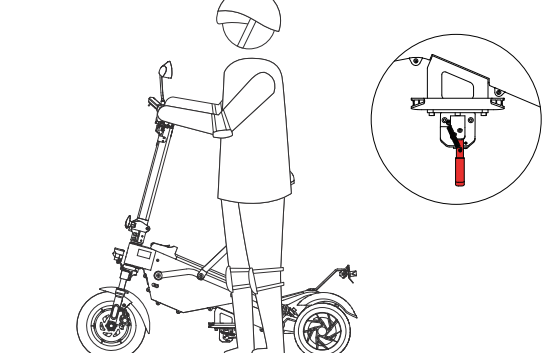

7. Get off: After cycling, please park the scooter on the flat road and long press on to turn off the power; drop the foot support to avoid slipping or falling.

How to charge

Due to battery self-consumption during transportation and storage, it is normal for the battery to be low or no battery when used for the first time. Please charge according to the following charging steps. You can choose two ways for charging: outside charging and whole scooter charging. Do not allow minors to use the charging equipment.

① Whole scooter charging

Locate the charging port on the left side of the scooter body and open the rubber cover. First, connect the charger to the power outlet, then plug the other end of the charger into the charging port. After charging is complete, close the rubber cover.

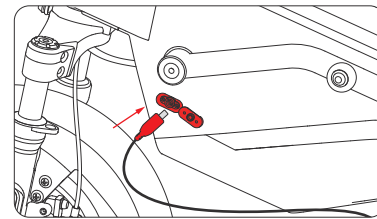
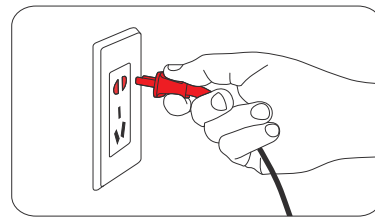
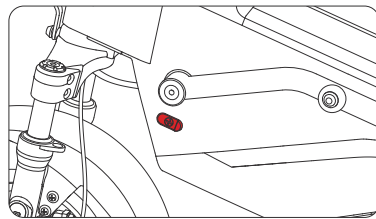

② External charging

Remove the battery and open the rubber cover of the charging port. First, connect the charger to the power outlet, then plug the other end of the charger into the battery's charging port. After charging is complete, close the rubber cover.

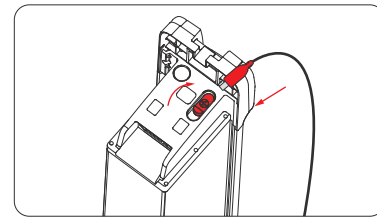
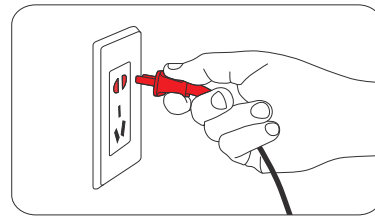
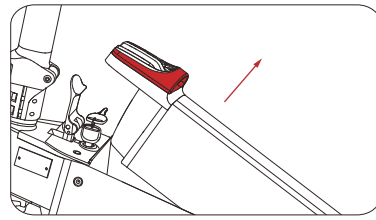

*The red light of the charger means the charger is working. The green light means the charging is finished. Please cut off the power after the battery is fully charged. If the temperature of the vehicle body exceeds 40 °C, the vehicle will not be charged normally. Please wait until it drops below 40 °C before charging.

Battery disassembly method

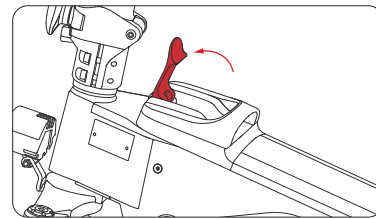

1. As shown, first open the lock on the battery case.

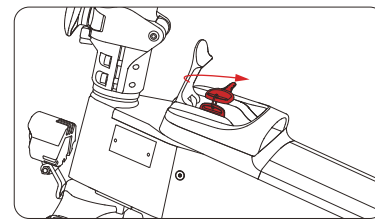

2. Use a special key to lock/open the battery cover on the body.

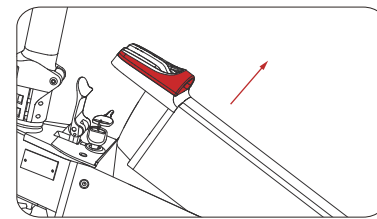

3. Hold the upper end of the battery box and lift the handle.

Frame and Motor Codes

The number is engraved on the end cover of the motor, as shown in the figure below:

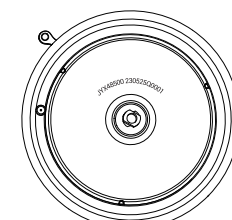

Left Motor

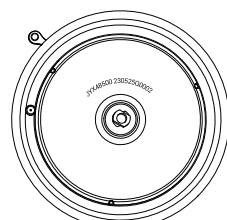

Right Motor

The location of the frame number is shown in the figure below:

